

Specifications

Nominal Voltage		12 V
Capacity (25°C)	10HR(10.8V)	65 Ah
	5HR(10.5V)	57Ah
	1HR(9.60V)	40Ah
Dimension	Length	350±2mm (13.78inch)
	Width	167±2mm (6.57inch)
	Height	179±2mm (7.05inch)
	Total Height	179±2mm (7.05inch)
Approx. Weight		19.6kg
Terminal type		F14
Internal resistance (Fully charged, 25°C)		Approx. 6mΩ
Capacity affected by temperature (10HR)	40°C	102%
	25°C	100%
	0°C	85%
	-15°C	65%
Self-discharge (25°C)	3 month	Remaining Capacity: 91%
	6 month	Remaining Capacity: 82%
	12 month	Remaining Capacity: 65%
Nominal operating temperature		25°C ± 3°C (77°F ± 5°F)
Operating temperature range	Discharge	-15°C ~ 50°C (5°F ~ 122°F)
	Charge	-10°C ~ 50°C (14°F ~ 122°F)
	Storage	-20°C ~ 50°C (-4°F ~ 122°F)
Float charging voltage(25°C)		13.50 to 13.80V Temperature compensation: -18mV/°C
Cyclic charging voltage(25°C)		14.50 to 15.00V Temperature compensation: -30mV/°C
Maximum charging current		19.5A
Maximum discharge current		650A(5 sec.)
Designed floating life(20°C)		10 years

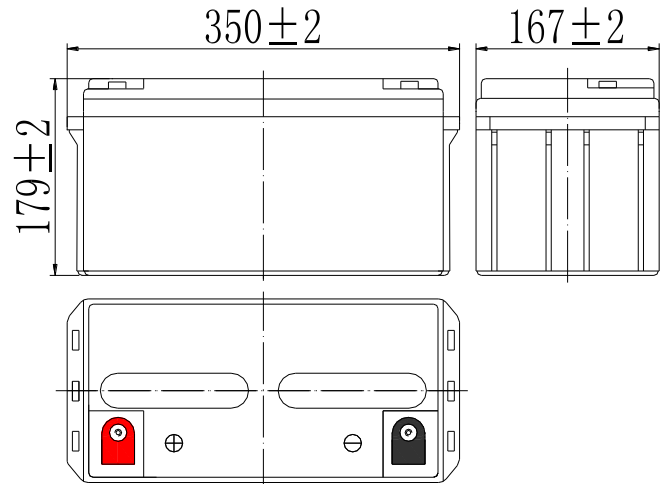

Dimensions



Terminal

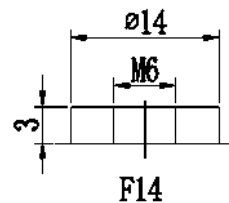

Constant Current Discharge Characteristics (A, 25°C)

F.V/TIME	10min	15min	30min	60min	2h	3h	4h	5h	8h	10h	20h
9.60V	142	109	65.3	40.2	23.8	16.9	13.7	11.7	8.02	6.62	3.51
9.90V	137	107	64.0	39.6	23.6	16.8	13.6	11.6	7.98	6.60	3.50
10.2V	132	103	62.1	38.6	23.4	16.7	13.5	11.5	7.92	6.58	3.49
10.5V	126	99.2	60.6	37.8	23.0	16.6	13.4	11.4	7.87	6.55	3.47
10.8V	119	93.9	58.3	36.6	22.5	16.1	13.0	11.1	7.63	6.50	3.45

Constant Power Discharge Characteristics (Watt, 25°C)

F.V/TIME	10min	15min	30min	60min	2h	3h	4h	5h	8h	10h	20h
9.60V	1530	1199	733	458	275	199	161	138	95.3	79.0	42.1
9.90V	1484	1170	718	451	273	198	160	137	94.7	78.9	42.0
10.2V	1423	1127	696	440	271	196	159	136	94.1	78.6	41.9
10.5V	1362	1089	679	430	267	195	157	135	93.4	78.2	41.6
10.8V	1286	1031	655	417	260	189	153	131	90.6	77.6	41.3

Note: The above characteristics data can be obtained within three charge/discharge cycles.

Construction

Component	Positive plate	Negative plate	Container	Cover	Separator	Electrolyte	Safety valve	Terminal
Raw material	Lead dioxide	Lead	ABS	ABS	AGM	Sulfuric acid	Rubber	Copper

Discharge Characteristics(25°C)

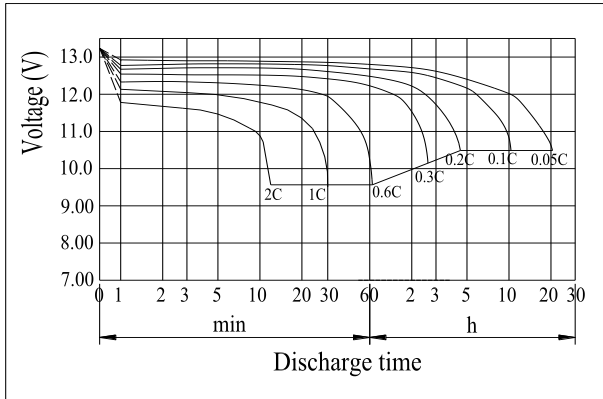

Charging Characteristics(25°C)

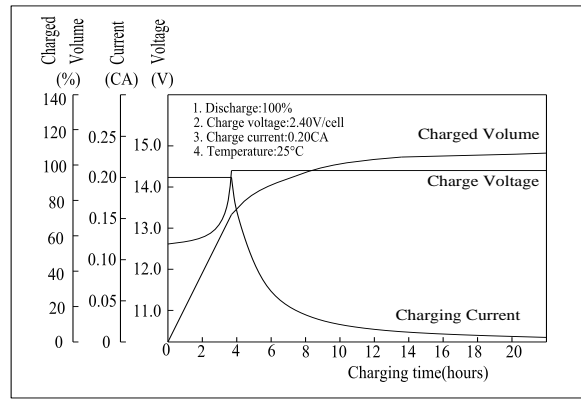

The Relationship for Open Circuit Voltage and Residual Capacity (25°C)

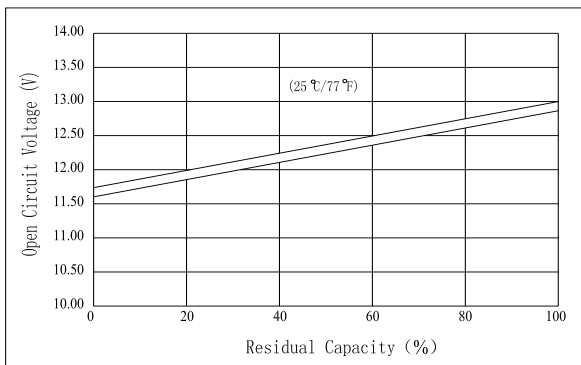

The Relationship for Charging Voltage and Temperature

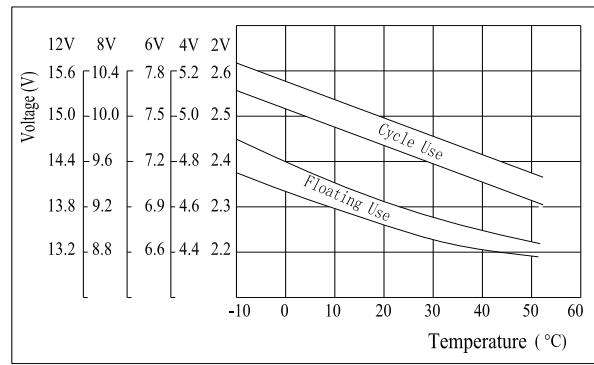

Floating Life on Temperature

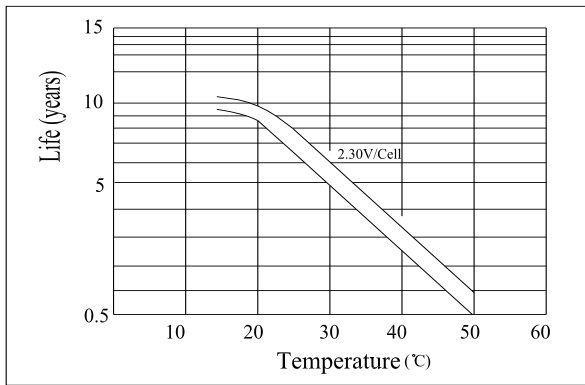

Cycle Life on D.O.D(25°C)

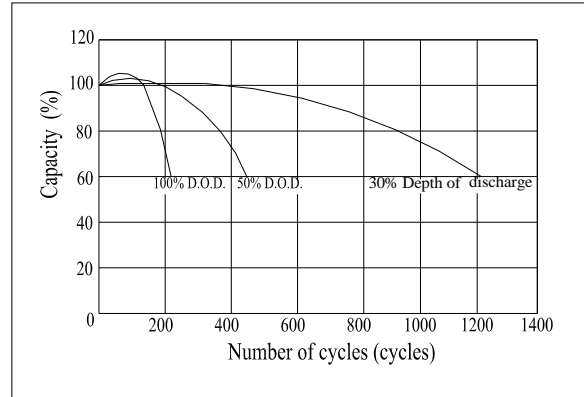

Effect of Temperature on Capacity

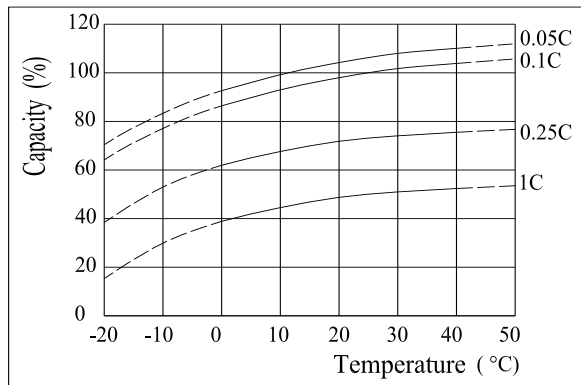

Self-discharge Characteristics

